

# State of Wyoming Corner Record

(In compliance with the *CORNER PERPETUATION AND FILING ACT*, Wyoming Statutes, 1997 Section 33-29-140 et. seq., and the Rules and Regulations of the Board of Professional Engineers and Professional Land Surveyors)

Reverse side of this form may be used if more space is needed.

Record of original survey and citation of source of historical information (if corner is lost or obliterated). Description of corner monumentation evidence found and/or monument and accessories established to perpetuate the location of this corner. Sketch of relative location of monument, accessories, and reference points with course and distance to adjacent corner(s) (if determined in this survey). Method and rationale for reestablishment of lost or obliterated corner.

U.S.G.L.O. 1871 Record: Set a granite boulder 16x8x4 for quarter section corner.

Found a 2-1/2" Aluminum Cap by PLS 2500 on a no. 5 rebar 0.8' below the road gravel surface, inscribed as shown below.

Set 2-1/2" aluminum cap on a 30" no. 6 rebar 1.0' below ground

Set 2-1/2" aluminum cap on a 30" no. 6 rebar 1.0' below ground

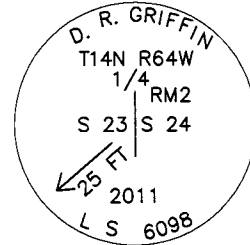
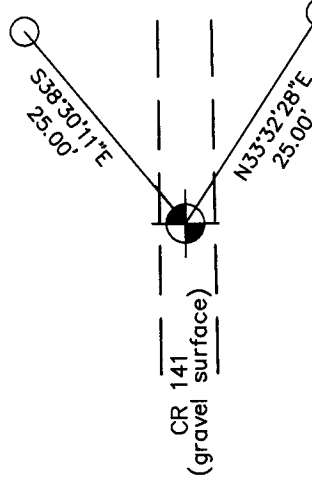

## Monument location

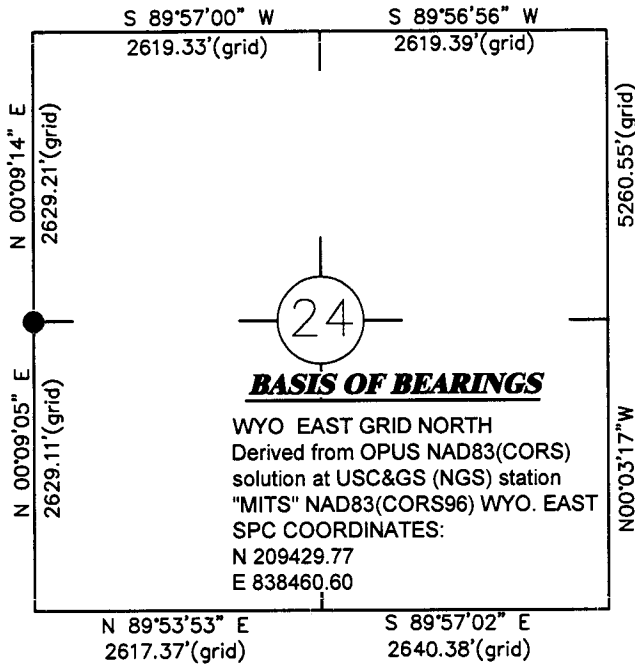

### BASIS OF BEARINGS

WYO EAST GRID NORTH  
Derived from OPUS NAD83(CORS)  
solution at USC&GS (NGS) station  
"MITS" NAD83(CORS96) WYO. EAST  
SPC COORDINATES:  
N 209429.77  
E 838460.60



WYO. SPC EAST GRID NORTH

Found a 2-1/2" Aluminum Cap by PLS 2500 on a no. 5 rebar 0.8' below the road gravel surface, inscribed as shown below.

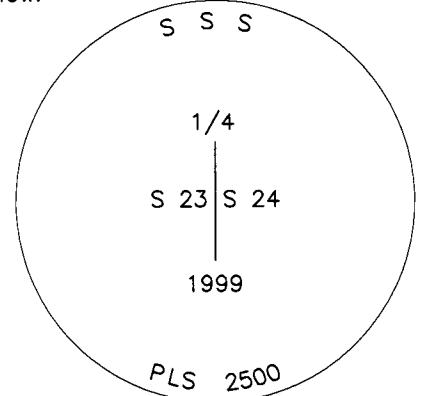

## Monument Inscription

Date of Field Work: 7/7/11

Office Reference: 18717

## Cross Index Plat

1	2	3	4	5	6	7	8	9	10	11	12	13	14	15	16	17	18	19	20	21	22	23	24	25	
A																									A
B																									B
C		6		5		4		3		2		1													C
D																									D
E																									E
F																									F
G			7		8		9		10		11		12												G
H																									H
J																									J
K																									K
L			18		17		16		15		14		13												L
M																									M
N																									N
O																									O
P			19		20		21		22		23		24												P
Q																									Q
R																									R
S																									S
T			30		29		28		27		26		25												T
U																									U
V																									V
W																									W
X			31		32		33		34		35		36												X
Y																									Y
Z																									Z
1	2	3	4	5	6	7	8	9	10	11	12	13	14	15	16	17	18	19	20	21	22	23	24	25	

Firm/Agency, Address

RONALD C. RENNKE  
D. R. GRIFFIN & ASSOCIATES  
1414 ELK STREET  
ROCK SPRINGS, WYOMING 82901  
Telephone Number: (307) 362-5028

This corner record was prepared by me or under my direction and supervision.

*SEAL & SIGNATURE*



RECORDED 8/09/2011 AT 10:17 AM REC# 573793 BK# 2231 PG# 477  
DEBRA K. LATHROP, CLERK OF LARAMIE COUNTY, WY PAGE 1 OF 1

Corner Name West 1/4 Corner Section 24, T 14 N, R 64 W, 6th P.M.  
County: Laramie, Wyoming

Cross-Index No.: P-21